

THE FIRE SAFE S- P- TOP

COMPANY INTRODUCTION

Jiaxing Top-Safe Fire-Fighting Equipment Co.,Ltd.

is one of the leading suppliers of fire safety equipment in China. As a total-solution supplier, Top-Safe specializes in supplying a wide variety of fire products with reliable quality in accordance with global standards base, including:

- ***Portable & Trolley dry chemical powder / foam / water / CO2 fire extinguisher***
- ***Landing valve,breeching inlet,coupling,nozzle and other casting & forging materials***
- ***Hose reel,hose rack and cabinet***
- ***Gate valve,check valve and alarm system***
- ***Fire pipeline & fittings***

Apart from above specified materials, we are also able to supply customized products to meet different requirements or any special needs. Being a responsible company, we always make every effort to provide our clients with best service, whenever Top-Safe stands for a guarantee of quality and responsibility. We have established steady business relationship with clients from 30 countries all over the world,and we never stop seeking new business opportunity in this field.

In 2015 Top-Safe opened its first overseas company in New Zealand,which is known as Top-Safe Fire Limited (NZ).Under Top-Safe (NZ) we expect to get the SAI Global License (Five-Ticks Approval) for our fire extinguisher to cater the demands of Oceania market.In the future, we will apply for more certificates and approvals to meet the needs of our clients as well as the market.

CONTENTS

■ DRY POWDER FIRE EXTINGUISHER	01-03
■ CO2 FIRE EXTINGUISHER	04
■ FOAM FIRE EXTINGUISHER	05
■ DRY POWDER AUTOMATIC FIRE EXTINGUISHER	06
■ TROLLEY FIRE EXTINGUISHER	07-08
■ FIRE EXTINGUISHER CYLINDER	09-11
■ FIRE EXTINGUISHER VALVE	12-16
■ FIRE EXTINGUISHER ACCESSORIES	17-18
■ SPRINKLER	19-20
■ VALVE	21-23
■ FIRE HOSE & HOSE REEL	24-26
■ HOSE REEL CABINET	27-28
■ NOZZLE & BRANCHPIPE	29-30
■ COUPLING & ADAPTOR	31-34
■ HYDRANT & SYSTEM VALVE	35-37
■ FIRE ALARM CABLE	38

**TSF01-01A****TSF01-02A****TSF01-03A****TSF01-06A****TSF01-09A**

Product Code	TSF01-01A	TSF01-02A	TSF01-03A	TSF01-06A	TSF01-09A
Out-diameter (mm)	Φ85	Φ110	Φ130	Φ160	Φ185
Cylinder high (mm)	277	306.5	308	427	453
Cylinder weight (kg)	0.77	1.13	1.56	2.82	3.77
Extinguisher weight (kg)	2.25	3.5	5	9.45	13.2
Volume (L)	1.3	2.35	3.5	7.6	10.2
Filling charge	1kg40%ABC	2kg40%ABC	3kg40%ABC	6kg40%ABC	9kg40%ABC
Temperature range (°C)	-20℃~+60℃	-20℃~+60℃	-20℃~+60℃	-20℃~+60℃	-20℃~+60℃
Working pressure (bar)	15	15	15	15	15
Test pressure (bar)	30	30	30	30	30
Material	DC01	DC01	DC01	DC01	DC01
Fire rating	8A 34B	13A 55B	21A 70B	34A 183B	43A 183B
Packing specification (mm)	275*205*360/6PCS	345*260*390/6PCS	280*280*385/4PCS	170*170*535	195*195*560



TSF01-06C1

TSF01-09C1

TSF01-06C2

TSF01-09C2

Product Code	TSF01-06C1	TSF01-09C1	TSF01-06C2	TSF01-09C2
Out-diameter (mm)	Φ 160	Φ 185	Φ 160	Φ 182
Cylinder high (mm)	402	476	400	470
Cylinder weight (kg)	2.2	3.9	2.4	3.1
Extinguisher weight (kg)	10	14.8	10.5	14.6
Volume (L)	7	11.2	7	10.8
Temperature range (°C)	-25℃~+60℃	-25℃~+60℃	-20℃~+60℃	-20℃~+60℃
Filling charge	6kg40%ABC(EN615)	9kg40%ABC(EN615)	6kg40%ABC(EN615)	9kg40%ABC(EN615)
Working pressure (bar)	15	15	15	15
Test pressure (bar)	30	30	27	27
Material	DC01	DC01	DC01	DC01
Internal gas cartridge	150g	180g	150g	180g
Drive gas	CO ₂	CO ₂	CO ₂	CO ₂
Fire rating	27A 144B	34A 183B	27A 144B	34A 183B
Packing specification (mm)	170*170*530	195*195*605	180*180*485	200*200*535

**TSF01-010A****TSF01-015A****TSF01-025A****TSF01-045A****TSF01-090A**

Product Code	TSF01-010A	TSF01-015A	TSF01-025A	TSF01-045A	TSF01-090A
Out-diameter (mm)	Φ90	Φ110	Φ130	Φ150	Φ182
Cylinder high (mm)	245	245	300	385	500
Cylinder weight (kg)	0.65	1.02	1.40	2.10	3.66
Extinguisher weight (kg)	2.01	3.06	4.45	7.22	13.5
Volume (L)	1.25	1.76	2.95	5.6	10.6
Filling charge	1kg50%ABE	1.5kg50%ABE	2.5kg50%ABE	4.5kg50%ABE	9kg50%ABE
Temperature range (°C)	-20°C~+60°C	-20°C~+60°C	-20°C~+60°C	-20°C~+60°C	-20°C~+60°C
Working pressure (bar)	13.5	13.5	13.5	13.5	13.5
Test pressure (bar)	27	27	27	27	27
Material	ST12	ST12	ST12	ST12	ST12
Fire rating	1A:10B:E	1A:20B:E	2A: 30B:E	4A: 60B:E	6A: 80B:E



TSF02-02B

TSF02-05B

TSF02-02C

TSF02-05C

Product Code	TSF02-02B	TSF02-05B	TSF02-02C	TSF02-05C
Out-diameter (mm)	Φ 103	Φ 135.8	Φ 111	Φ 159
Cylinder high (mm)	475	650	475	580
Cylinder weight (kg)	3.6	7.9	3.26	8.26
Extinguisher weight (kg)	6.4	13.5	6	13.8
Volume (L)	3.0	7.5	3.0	7.5
Filling charge	2kgCO ₂	5kgCO ₂	2kgCO ₂	5kgCO ₂
Temperature range (°C)	-30°C~+60°C	-30°C~+60°C	-30°C~+60°C	-30°C~+60°C
Working pressure (bar)	174	174	174	174
Test pressure (bar)	250	250	250	250
Material	34Cr m04	34Cr m04	A6061	A6061
Fire rating	34B	89B	34B	89B
Packing specification (mm)	170*120*595	170*145*770	170*120*595	170*170*690

**TSF03-06A****TSF03-09A****TSF03-06B****TSF03-09B**

Product Code	TSF03-06A	TSF03-09A	TSF03-06B	TSF03-09B
Out-diameter (mm)	Φ 160	Φ 185	Φ 180	Φ 180
Cylinder high (mm)	433	474	400	545
Cylinder weight (kg)	2.8	4.3	2	2.6
Extinguisher weight (kg)	9.5	14	8.6	12.2
Volume (L)	7.2	10.7	8.89	12.5
Filling charge	6LAFFF3%	9LAFFF3%	6LAFFF3%	9LAFFF3%
Temperature range (°C)	+5°C~+60°C	+5°C~+60°C	+5°C~+60°C	+5°C~+60°C
Working pressure (bar)	15	15	15	15
Test pressure (bar)	30	30	27	27
Material	DC01	DC01	SUS304	SUS304
Fire rating	13A 144B	21A 233B	13A 144B	21A 233B
Packing specification (mm)	170*170*575	195*195*620	190*190*510	190*190*655



TSF04-045A



TSF04-06A



TSF04-12A

Product Code	TSF04-045A	TSF04-06A	TSF04-12A
Out-diameter (mm)	Φ 180	Φ 213	Φ 302
Cylinder high (mm)	260	285	268
Cylinder weight (kg)	1.85	3.8	7
Extinguisher weight (kg)	6.7	10.2	19.5
Volume (L)	5.5	8.46	13.9
Filling charge	4.5kg40%ABC(EN615)	6kg40%ABC(EN615)	12kg40%ABC(EN615)
Temperature range (°C)	-20°C~+60°C	-20°C~+60°C	-20°C~+60°C
Working pressure (bar)	15	15	15
Test pressure (bar)	26.5	26.5	26.5
Material	DC01	DC01	DC01
Fire rating	21A 70B	27A 144B	43A 183B
Packing specification (mm)	190*190*425	425*220*245	400*320*340

**TSF01-25C****TSF01-25A****TSF01-50A**

Product Code	TSF01-25C	TSF01-25A	TSF01-50A
Out-diameter (mm)	Φ 270	Φ 250	Φ 300
Cylinder high (mm)	625	661	918
Cylinder weight (kg)	20	10.5	20
Extinguisher weight (kg)	60	55	92
Volume (L)	30	29.5	59.5
Filling charge	25kg40%ABC(EN615)	25kg40%ABC(EN615)	50kg40%ABC(EN615)
Temperature range (°C)	-20℃~+55℃	-30℃~+55℃	-30℃~+55℃
Working pressure (bar)	15	15	15
Test pressure (bar)	35	35	35
Material	HP245	HP245	HP245
Drive gas	CO ₂ (0.67kg)		
Fire rating	55A IB	55A IB	55A IIB
Packing specification (mm)	450*440*950	450*450*1100	500*500*1200



TSF02-10B



TSF03-50C



TSF03-50A

Product Code	TSF02-10B	TSF03-50C	TSF03-50A
Out-diameter (mm)	Φ 165	Φ 320	Φ 300
Cylinder high (mm)	915	875	918
Cylinder weight (kg)	20.5	32	25
Extinguisher weight (kg)	36	100	97
Volume (L)	15	59	59.5
Filling charge	10kgCO ₂	AFFF3%	AFFF3%
Temperature range (°C)	-30°C~+60°C	+5°C~+55°C	+5°C~+55°C
Working pressure (bar)	174	15	15
Test pressure (bar)	250	35	35
Material	34CrMo4 Steel	HP245	HP245
Drive gas		N2(2.5L)	
Fire rating	183B	55A IIB	55A IIB
Packing specification (mm)	360*330*1200	530*480*980	500*500*1200

**TSF00-01D****TSF00-02D****TSF00-03D****TSF00-06D****TSF00-09D**

Product Code	TSF00-01D	TSF00-02D	TSF00-03D	TSF00-06D	TSF00-09D
Out-diameter (mm)	Φ90	Φ110	Φ130	Φ150	Φ180
Cylinder high (mm)	243	316	374	475	505
Cylinder weight (kg)	0.75	1.1	1.5	2.6	3.8
Volume (L)	1.24	2.3	4.1	7.2	11
Temperature range (°C)	-30℃~+60℃	-30℃~+60℃	-30℃~+60℃	-30℃~+60℃	-30℃~+60℃
Max working pressure (bar)	18.5	18.5	18.5	18.5	18.5
Test pressure (bar)	27	27	27	27	27
Material	DC01	DC01	DC01	DC01	DC01
Packing specification (mm)	380*290*260/12PCS	460*350*335/12PCS	540*410*395/12PCS	465*315*495/6PCS	375*375*525/4PCS



TSF00-01C

TSF00-02C

TSF00-04C

TSF00-06C

TSF00-09C

Product Code	TSF00-01C	TSF00-02C	TSF00-04C	TSF00-06C	TSF00-09C
Out-diameter (mm)	Φ88	Φ108	Φ138	Φ158	Φ178
Cylinder high (mm)	238	295	359	420	482
Cylinder weight (kg)	0.68	1.01	1.84	2.7	3.56
Volume (L)	1.2	2.4	4.7	7.1	10.6
Temperature range (°C)	-30℃~+60℃	-30℃~+60℃	-30℃~+60℃	-30℃~+60℃	-30℃~+60℃
Max working pressure (bar)	20	20	20	20	20
Test pressure (bar)	30	30	30	30	30
Material	DC01	DC01	DC01	DC01	DC01
Packing specification (mm)	375*280*260/12PCS	455*340*315/12PCS	430*290*380/6PCS	490*330*440/6PCS	370*370*500/4PCS

**TSF00-01B****TSF00-02B****TSF00-04B****TSF00-06B****TSF00-09B**

Product Code	TSF00-01B	TSF00-02B	TSF00-04B	TSF00-06B	TSF00-09B
Out-diameter (mm)	Φ85	Φ108	Φ130	Φ153	Φ180
Cylinder high (mm)	256	348	410	490	535
Cylinder weight (kg)	0.95	1.41	1.64	2.38	2.95
Volume (L)	1.2	2.68	4.7	8.0	12.0
Temperature range (°C)	-30℃~+60℃	-30℃~+60℃	-30℃~+60℃	-30℃~+60℃	-30℃~+60℃
Max working pressure (bar)	18	18	18	18	18
Test pressure (bar)	27	27	27	27	27
Material	SUS304	SUS304	SUS304	SUS304	SUS304
Packing specification (mm)	355*440*265/20PCS	225*340*360/6PCS	270*270*425/4PCS	160*320*505/2PCS	190*380*550/2PCS

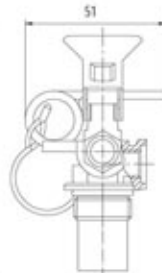
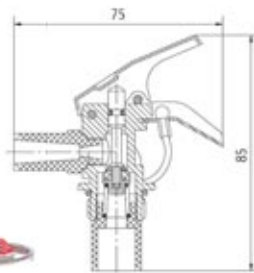

TSA01-01B

Inlet Thread	Outlet Thread	Gauge Connection Thread	Dip Tube Thread
1/2"BSP	M10×1	1/8"BSP	Φ14±0.05

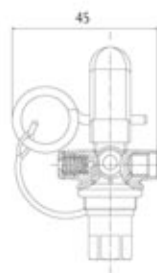
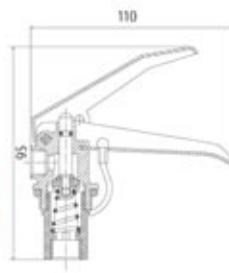

TSA01-02A

Inlet Thread	Outlet Thread	Gauge Connection Thread	Dip Tube Thread	Pressure MPa
M24×1.5	M12×1.5	M10×1-12.5	M14×1.5	2.1-2.6

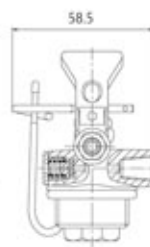
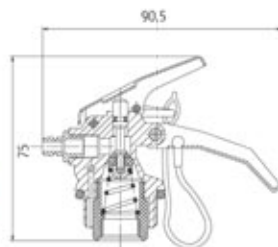

TSA01-03A

Inlet Thread	Outlet Thread	Gauge Connection Thread	Dip Tube Thread	Pressure MPa
M30×1.5	1/8"BSP	1/8-27NPT	M16×1.5	2.1-2.6

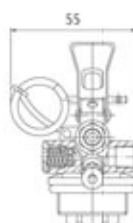
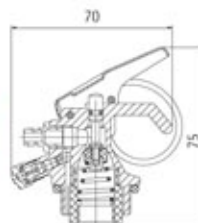

TSA01-04A

Inlet Thread	Outlet Thread	Gauge Connection Thread	Dip Tube Thread	Pressure MPa	Check Valve
M30×1.5	1/8" BSP	1/8-27NPT	M16×1.5	2.1-2.6	Valve

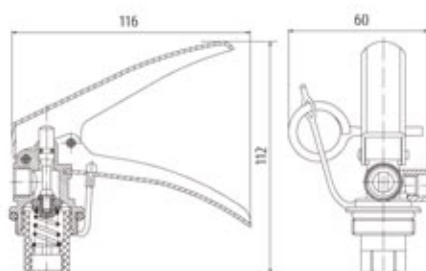

TSA01-05B

Inlet Thread	Outlet Thread	Gauge Connection Thread	Dip Tube Thread
M30×1.5	M16×1.5	M8×1	M16×1.5

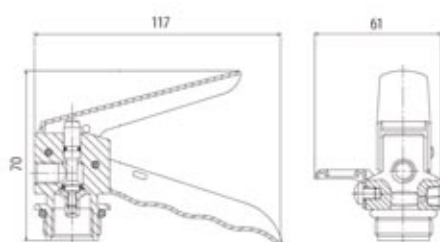

TSA01-06A

Inlet Thread	Outlet Thread	Gauge Connection Thread	Dip Tube Thread
1 1/16-12UN	3/8-24UNF	1/8-27NPT	Φ16

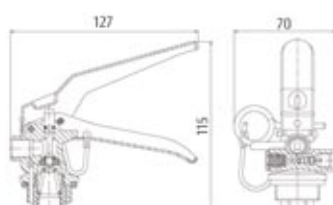

TSA01-07A

Inlet Thread	Outlet Thread	Gauge Connection Thread	Dip Tube Thread	Pressure MPa	Check Valve
M30×1.5	1/4" BSP	M10×1-12.5	M16×1.5	2.1-2.6	Valve

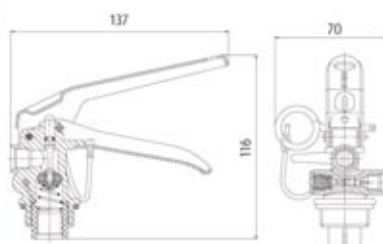

TSA01-08A

Inlet Thread	Outlet Thread	Gauge Connection Thread	Dip Tube Thread	Pressure MPa	Check Valve
M30×1.5	1/4" BSP	M10×1-12.5	M16×1.5	2.1-2.6	Valve

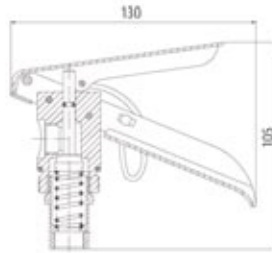

TSA02-05B

Inlet Thread	Outlet Thread	Gauge Connection Thread	Dip Tube Thread
1 1/4-12NUF	5/8-18UNF	1/8-27NPT	Φ11

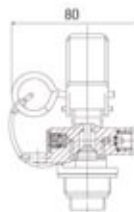
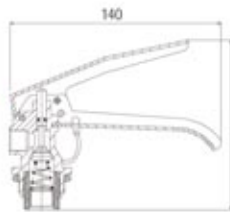

TSA02-06A

Inlet Thread	Outlet Thread	Gauge Connection Thread	Dip Tube Thread	Pressure MPa	Check Valve
M30×1.5	M14×1.5	M10×1-12.5	M16×1.5	2.1-2.6	Check

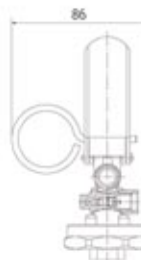
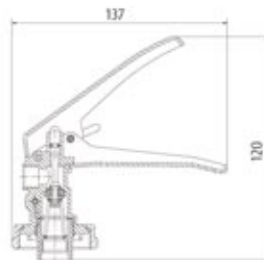

TSA02-07A

Inlet Thread	Outlet Thread	Gauge Connection Thread	Dip Tube Thread	Check Valve
M45×1.5	M14×1.5	M10×1-12.5	M16×1.5	Valve

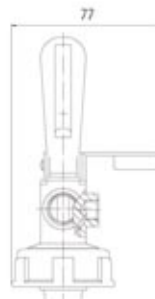
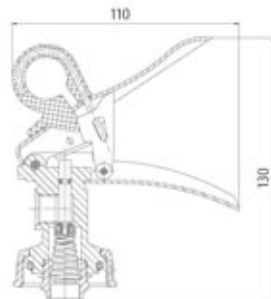

TSA02-08A

Inlet Thread	Outlet Thread	Gauge Connection Thread	Dip Tube Thread
M42×1.5	M14×1.25	1/8" BSP	M15×1

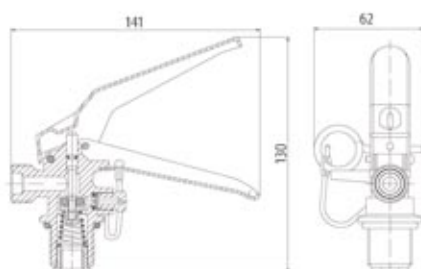
**TSA03-01C**

Inlet Thread	Outlet Thread	Dip Tube Thread	Pressure MPa
M25×2	Φ21.7×14	1/4"BSP	22.5±10%

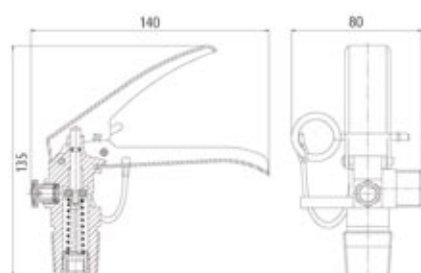
**TSA03-02C**

Inlet Thread	Outlet Thread	Dip Tube Thread	Pressure MPa
PZ27.8×14	Φ21.7×14	M10×1	22.5±10%

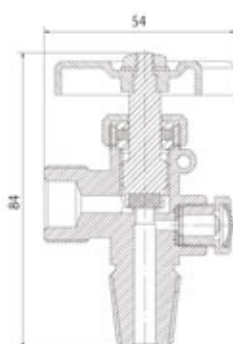
**TSA03-03C**

Inlet Thread	Outlet Thread	Dip Tube Thread	Pressure MPa
PZ19.2×14	Φ21.7×14	Φ6	22.5±10%

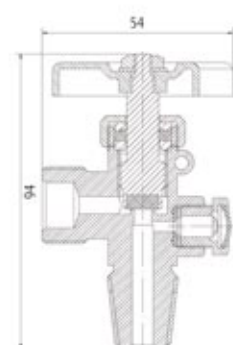
**TSA03-04C**

Inlet Thread	Outlet Thread	Dip Tube Thread	Pressure MPa
PZ19.2×14	Φ21.7×14	M10×1	26±10%

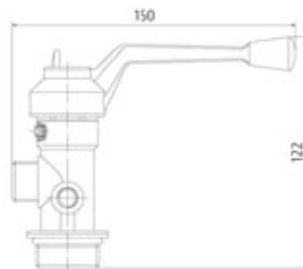

TSA05-01D

Inlet Thread	Outlet Thread	Gauge Connection Thread	Dip Tube Thread	Pressure MPa
1" BSP	1/2" BSP	1/8-27NPT	M24×1.5	2.1-2.6

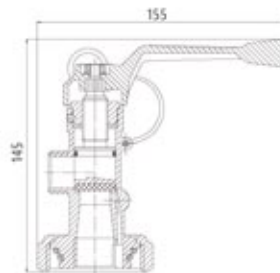

TSA05-02D

Inlet Thread	Outlet Thread	Gauge Connection Thread	Dip Tube Thread	Pressure MPa	Check Valve
2" BSP	3/4" BSP	M10×1-12.5	3/4" BSP	2.1-2.6	Valve

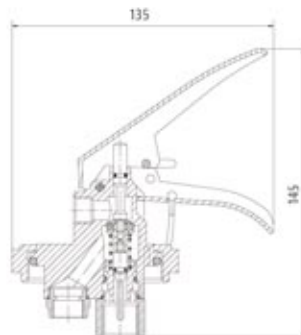

TSA05-03D

Inlet Thread	Outlet Thread	Dip Tube Thread	Pressure MPa
M74×2 / M18×1.5	M14×1.5	M16×1.5	1.8-2.2

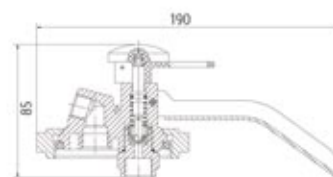

TSA05-04D

Inlet Thread	Outlet Thread	Dip Tube Thread	Pressure MPa
M74×2 / M18×1.5	M16×1.5	M16×1.5	2.1-2.6

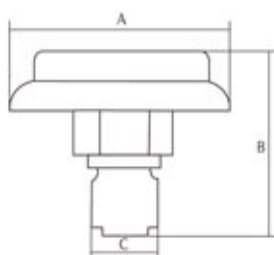
**TSI01-01A**

A	B	C
Φ37	29	M10×1
	29	M10×1-12.5
	28	1/8-27NPT

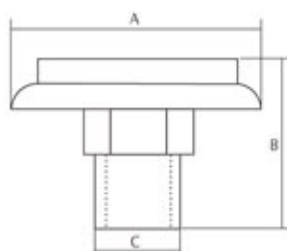
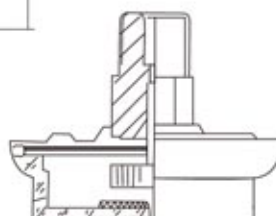
**TSI01-02A**

A	B	C
Φ30	29	M10×1
	29	M10×1-12.5
	28	1/8-27NPT

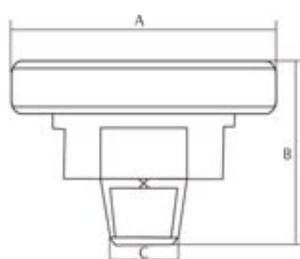
**TSI02-01A**

A	B	C
Φ35	26	M10×1
	26	M10×1-12.5
	25	1/8-27NPT

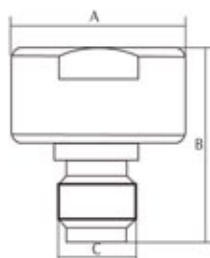
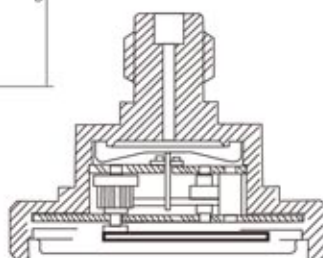
**TSI02-02A**

A	B	C
Φ23	26	M10×1
	26	M10×1-12.5
	25	1/8-27NPT



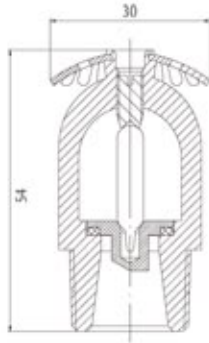

TSP01-01A

Inlet Thread	Temperature
1/2" BSPT	68°C

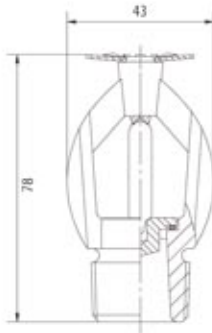

TSP01-02A

Inlet Thread	Temperature
1/2" BSPT	68°C

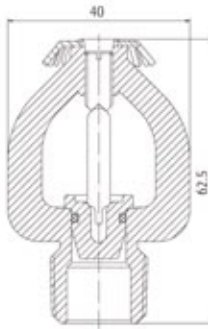

TSP01-03A

Inlet Thread	Temperature
1/2" BSPT	68°C

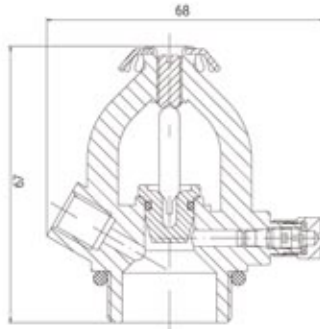

TSP01-04A

Inlet Thread	Gauge Connection Thread	Temperature	Check Valve
M30×1.5	1/8-27NPT	68°C	Valve

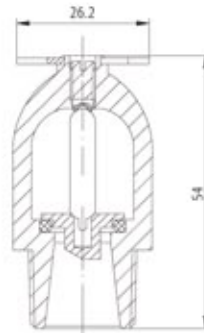

TSP01-05A

Inlet Thread	Temperature
1/2" BSPT	57°C / 68°C / 79°C / 93°C / 141°C

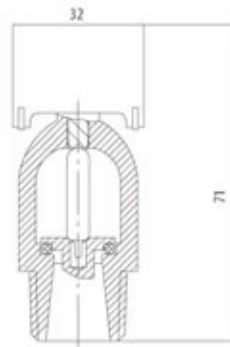

TSP01-06A

Inlet Thread	Temperature
1/2" BSPT	57°C / 68°C / 79°C / 93°C / 141°C

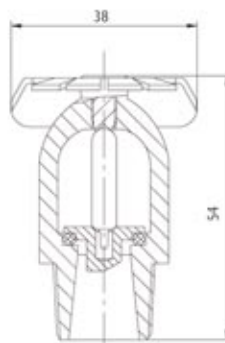

TSP01-07A

Inlet Thread	Temperature
1/2" BSPT	57°C / 68°C / 79°C / 93°C / 141°C

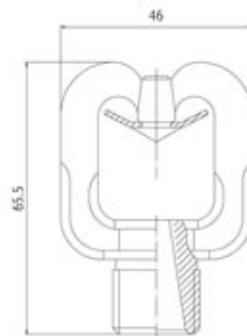

TSP01-08A

Inlet Thread	Aperture
1/2" BSPT	Φ10 / Φ6

Landing Valve Oblique Type



TSV01-01C

Size	H(mm)	W(mm)	Inlet	Outlet
DN65	205	218	2.5"BSPT	BS336
DN65	200	218	2.5"BSP	BS336
DN65	200	218	2.5"BSP(F)	BS336

Landing Valve Right-Angle Type



TSV01-02A

Size	H(mm)	W(mm)	Inlet	Outlet
DN50	198	213	165	BS336
DN65	198	223	185	BS336

Pressure Regulating Valve (PRV)



TSV01-03A

Size	H(mm)	W(mm)	Inlet	Outlet
DN50	380	225	165	BS336
DN65	380	225	185	BS336

SPECIFICATION OF HP LANDING VALVES

Standard	BS 5041-1
Body	Copper alloy, Thickness $\geq 4\text{mm}$
Handwheel	Grey cast iron alloy
Blank cap	Copper alloy or Plastic
Inlet	Flanged or BSP screwed
Outlet	Female instantaneous to BS336
Surface	Red or yellow painting
Test pressure	30 bar
Fully open	4.5 turns
Inlet pressure 20bar, regulating outlet static pressure 5~8bar	
Inlet pressure 30bar, regulating outlet static pressure >20bar	

Landing Valve Bib-nosed Type



TSV01-04A

Size	H(mm)	W(mm)	Inlet	Outlet
DN50	240	225	165	BS336
DN65	250	225	185	BS336

Diaphragm Valve

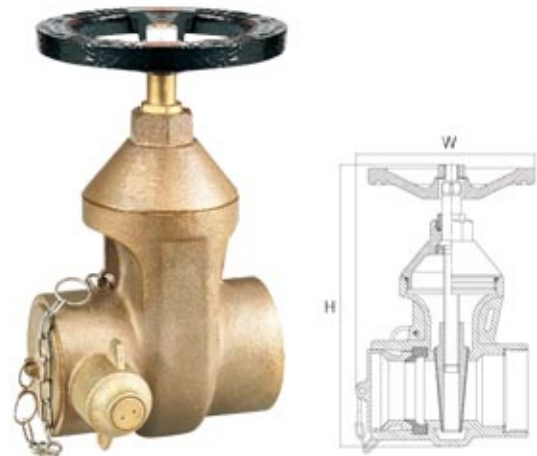

TSV01-05B

Size	H(mm)	W(mm)	Inlet	Outlet
DN65	255	155	2.5"BSPT	BS336
DN65	255	155	2.5"BSP	BS336
DN65	255	138	2.5"BSP(F)	BS336

Landing Valve



TSV01-06A

Size	H(mm)	W(mm)	Inlet	Outlet
DN50	200	225	165	BS336
DN65	205	218	2.5"BSP	BS336
DN65	200	235	185	BS336

Angle Valve



TSV01-07C

Size	H(mm)	W(mm)	Inlet	Outlet
DN40	177	105	1.5"NPT	1.5"NH
DN65	226	145	2.5"NPT	2.5"NH
DN40	177	105	1.5"NPT	1.5"NPT
DN65	226	145	2.5"NPT	2.5"NPT

Landing Valve



TSV01-08C

Size	H(mm)	W(mm)	Inlet	Outlet
DN40	125	110	1.5"BSP	1.5"BSP
DN45	129	112	1.5"BSP	M56×4
DN65	185	160	2.5"BSP	2.5"BSP
DN70	170	162	2.5"BSP	M85×6

Gate Valve with Key

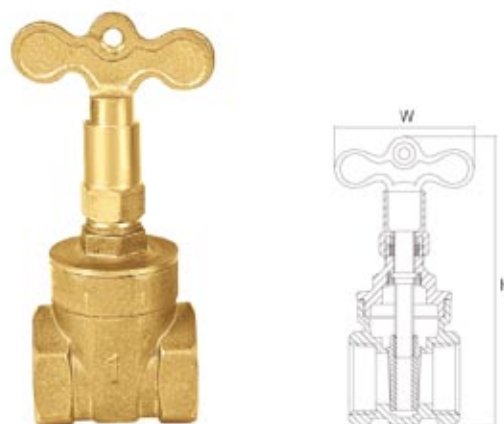

TSV01-09B

Size	H(mm)	W(mm)	Inlet	Outlet
DN25	135	65	1"BSPT	1"BSPT
DN25	135	65	1"BSP	1"BSP
DN40	165	65	1.5"BSP	1.5"BSP

2 Ways Breeching Inlet



TSV01-10A

Size	H(mm)	W(mm)	D(mm)	Connections
DN100	225	300	100	2×BS336
DN100	225	300	100	2×2.5"BSP

Pressure Regulating Valve

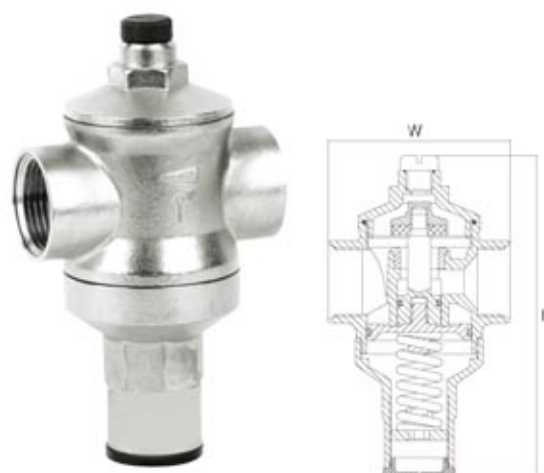

TSV01-11B

Size	H(mm)	W(mm)	Inlet	Outlet
DN25	152	86	1"BSP	1"BSP
DN40	171	91	1.5"BSP	1.5"BSP
DN50	171	91	2"BSP	2"BSP

Swivelling Fire Hose Reel

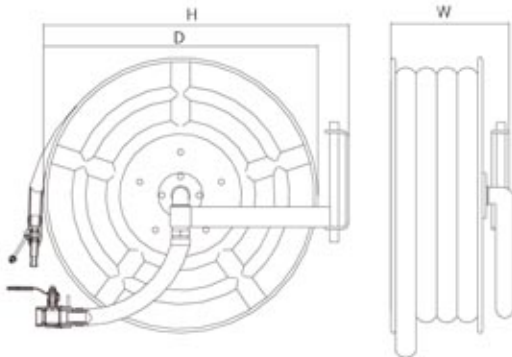

TSR01-01A

Size	H(mm)	W(mm)	D(mm)	Inlet	Outlet	Type
19mm×30M	600	220	580	1"BSP	6mm	Manual
25mm×30M	600	240	580	1"BSP	6mm	Manual
19mm×30M	600	220	580	1"BSP	8mm	Automatic
25mm×30M	600	240	580	1"BSP	8mm	Automatic

SPECIFICATION

Side plates 1mm cold rolled steel or stainless steel

RAL3000 polyester epoxy Powder coating

Unwind the hose without hose guide forces≤70N

Red or black fire hose to EN694 approve

Lever operated nozzle shut / jet / spray

Max working pressure 12bar, Test pressure 18bar

Swinging Fire Hose Reel

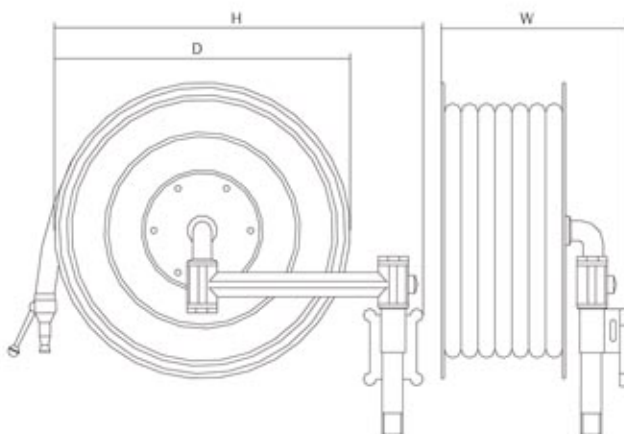

TSR01-02A

Size	H(mm)	W(mm)	D(mm)	Inlet	Outlet	Type
19mm×30M	570	280	525	1"BSP	6mm	Manual
19mm×30M	570	280	525	1"BSP	6mm	Automatic
25mm×30M	580	300	550	1"BSP	8mm	Manual
25mm×30M	580	300	550	1"BSP	8mm	Automatic



Automatic Fire Hose Reel

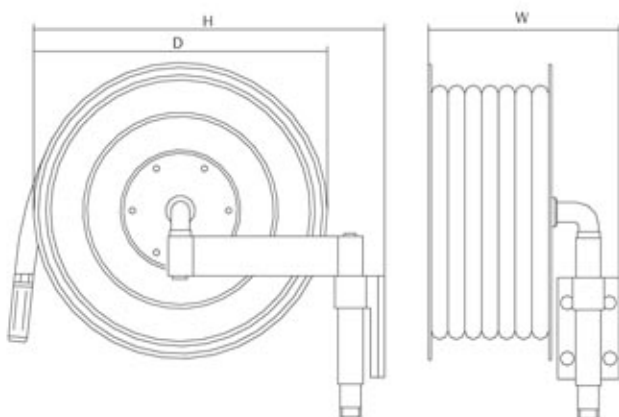

TSR01-03A

Size	H(mm)	W(mm)	D(mm)	Inlet	Outlet
19mm×20M	650	180	525	1"BSP	6mm
19mm×30M	650	220	525	1"BSP	6mm
25mm×20M	650	200	550	1"BSP	8mm
25mm×30M	650	250	550	1"BSP	8mm

Swinging Fire Hose Reel

Swinging Fire Hose Reel

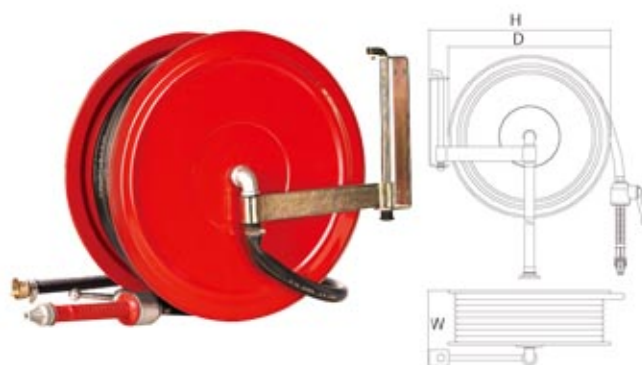
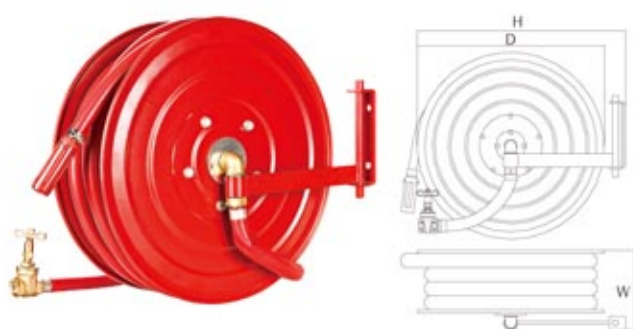

TSR01-04A

Size	H(mm)	W(mm)	D(mm)	Inlet	Outlet
19mm×20M	640	180	525	1"BSP	6mm
19mm×30M	640	220	525	1"BSP	6mm
25mm×20M	640	200	550	1"BSP	8mm
25mm×30M	640	250	550	1"BSP	8mm

TSR01-05A

Size	H(mm)	W(mm)	D(mm)	Inlet	Outlet
19mm×20M	530	200	455	1"BSP	4.5mm
19mm×25M	530	200	455	1"BSP	4.5mm
19mm×30M	530	200	525	1"BSP	4.5mm

Red PVC Fire Hose



TSR02-01A

Size	W.P	T.P	B.P
13mm	12bar	18bar	42bar
19mm	12bar	18bar	40bar
25mm	12bar	18bar	30bar
33mm	7bar	10.5bar	17.5bar

Black PVC Fire Hose



TSR02-02A

Size	W.P	T.P	B.P
13mm	12bar	18bar	42bar
19mm	12bar	18bar	40bar
25mm	12bar	18bar	30bar
33mm	7bar	10.5bar	17.5bar

Type 3 Fire Hose



TSR02-03A

Size	W.P	T.P	B.P
1.5"	17bar	26bar	51bar
2"	17bar	26bar	51bar
2.5"	17bar	26bar	51bar

Canvas Hose



TSR02-04A

Size	W.P	T.P	B.P
1.5"	13bar	20bar	39bar
2"	13bar	20bar	39bar
2.5"	13bar	20bar	39bar

Hose Reel Cabinet (Fixed Type)

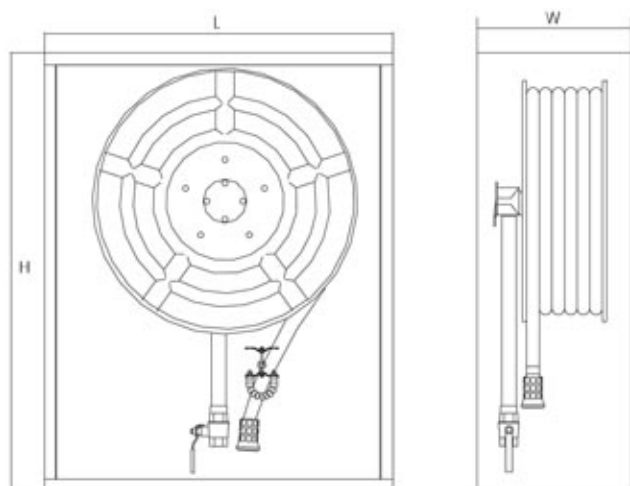

TSR03-01A

Size	Dimension	D(mm)	Inlet	Outlet
19mm×20M	1000×800×240	580	1"BSP	6mm
19mm×30M	1000×800×240	580	1"BSP	8mm
25mm×20M	1000×800×270	580	1"BSP	8mm
25mm×30M	1000×800×270	580	1"BSP	8mm

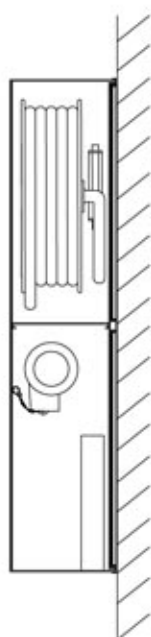

Wall-mounted

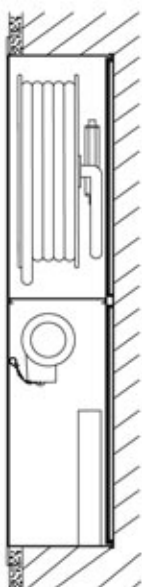

Recessed

SPECIFICATION

1mm cold rolled steel or stainless steel

Manufacture by CNC punching machine

RAL3000 polyester epoxy Powder coating

Magic plus Automatic coating line

3/4" or 1" hose reel EN 671-1 approve

Hose reel is mounted on arm which swings 180°

Fire hose rack 2.5" x 30 M & Landing valve

6kg Dry powder fire extinguisher

Stainless steel or Plastic doorlock

Wall-mounted or Recessed type

Fire Cabinet with Hose Rack

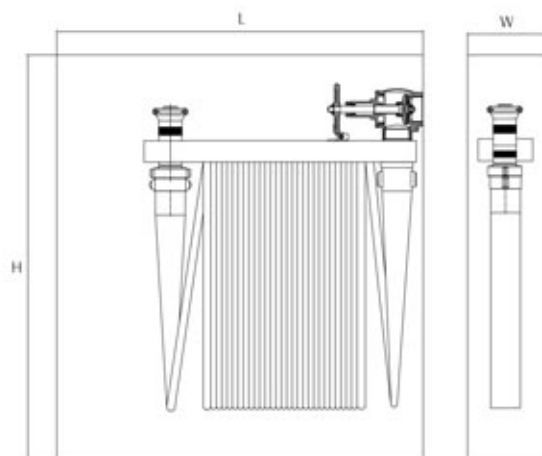

TSR03-02A

Size	Dimension	Connection	Inlet	Outlet
40mm×30M	800×700×160	1.5NH	1.5"NPT	15mm
40mm×30M	800×700×160	1.5NH	2.5"NPT	15mm
65mm×30M	800×750×200	2.5NH	2.5"NPT	20mm

Hose Reel Cabinet (Double Compartment)

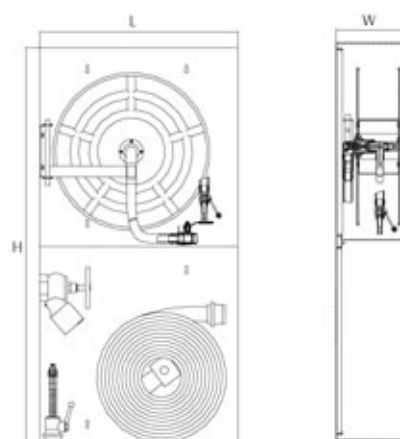

TSR03-03A

Size	Dimension	D(mm)	Inlet	Outlet
19mm×20M	1450×720×250	580	1"BSP	6mm
19mm×30M	1450×720×250	580	1"BSP	6mm
25mm×20M	1450×720×280	580	1"BSP	8mm
25mm×30M	1450×720×280	580	1"BSP	8mm

Jet/Spray Nozzle

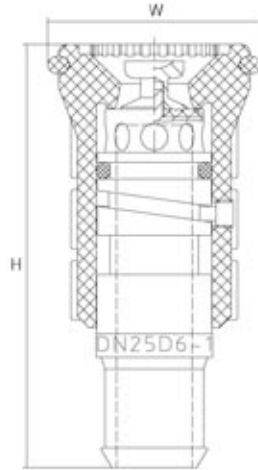

TSJ01-01A

Size	H(mm)	W(mm)	Inlet	Outlet
DN19	110	55	19mm	D6
DN25	110	55	25mm	D8
DN25	95	55	1" BSP	D9
DN25	120	55	Storz-D	D10

Fire Hose Reel Nozzle Flow Rates

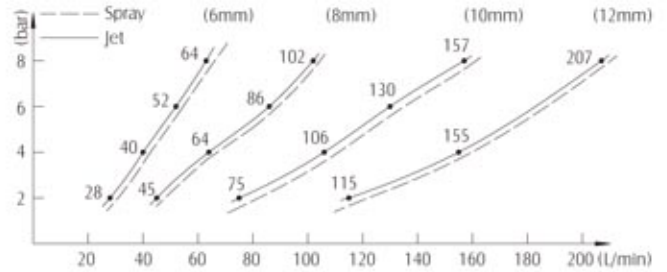

Rotary operated

Operating torques 4N·M(7N·M)

Jet throw range ≥ 10M

Spray discharge ≥ 90°

WP: 12bar(7bar)

TP: 18bar(10.5bar)

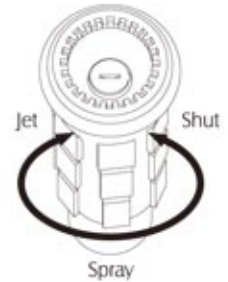

Jet/Spray Nozzle

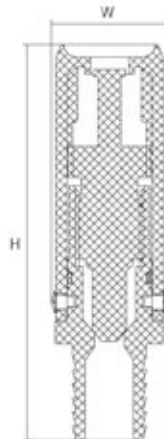

TSJ01-02A

Size	H(mm)	W(mm)	Inlet	Outlet
DN19	140	41	19mm	D6
DN19	140	41	19mm	D8
DN25	140	41	25mm	D8
DN25	140	41	25mm	D10

Spray/Jet Nozzle

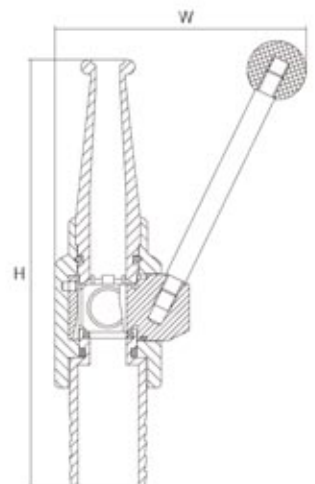

TSJ01-03A

Size	H(mm)	W(mm)	Inlet	Outlet
DN13	132	82	13mm	D4
DN19	141	83	19mm	D6
DN25	141	83	25mm	D8

Jet/Spray Branchpipe



TSJ02-04A

Size	H(mm)	W(mm)	Inlet	Outlet
DN50	407	165	G2"	9mm
CM	440	165	Storz-C	9mm
DN65	440	165	BS336	12.5mm

Jet/Spray Branchpipe with Water Curtain

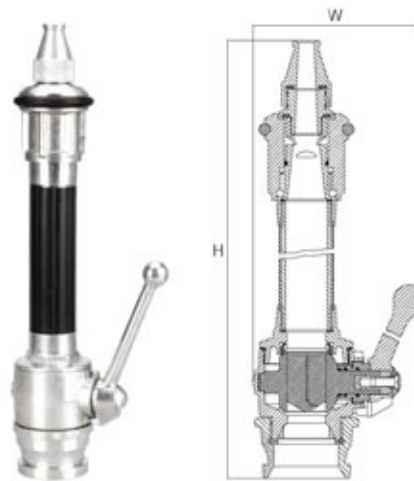

TSJ02-05A

Size	H(mm)	W(mm)	Inlet	Outlet
DN50	405	165	G2"	9mm
CMM	440	165	Storz-C	9mm
DN65	440	165	BS336	12.5mm

Jet/Spray Branchpipe

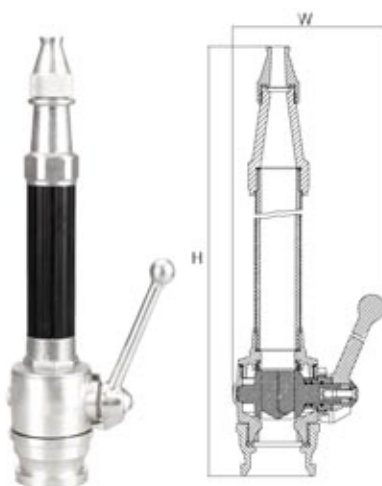

TSJ02-06A

Size	H(mm)	W(mm)	Inlet	Outlet
DN50	390	165	G2"	9mm
CMM	415	165	Storz-C	9mm
DN65	415	165	BS336	12.5mm

TSJ01-04/05/06A Branchpipe Flow Rates

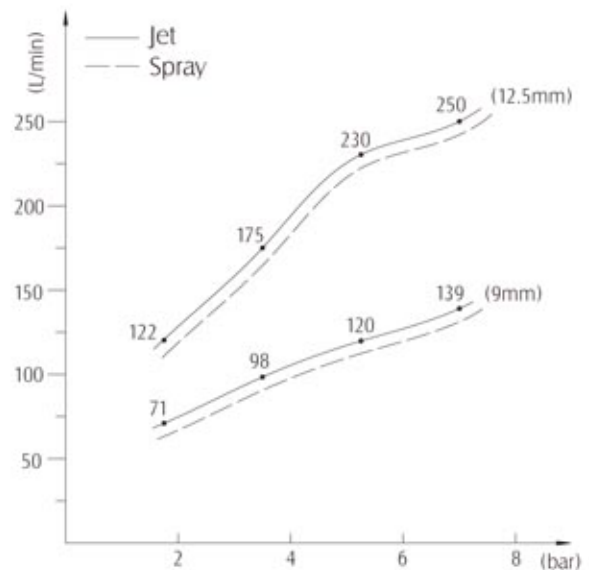

Standard: BS 336
 Aluminium alloy to BS 1490
 Ball valve control
 Water curtain angle $\geq 180^\circ$

John Morris Hose Coupling / Aluminium



TSL01-01C

Size	H(mm)	W(mm)	D(mm)	Head	Tail
1-1/2"	195	182	26.6	BS336	38mm
1-3/4"	195	182	32.9	BS336	45mm
2"	195	182	38.5	BS336	51mm
2-1/2"	195	182	51.2	BS336	63.5mm
2-3/4"	195	182	56.8	BS336	75mm

SPECIFICATION OF HOSE COUPLING

Standard: BS 336

PART	LM25	6061	CW617N	CW614N	CC491K
Male coupling	✓		✓		✓
Female coupling	✓		✓		✓
Release handle	✓		✓		✓
Release plunger		✓		✓	

Release Force $45N \leq x \leq 65N$

Natural rubber washer to BS 1154

Multi-serrated & Ribbed type

John Morris Hose Coupling / Bronze



TSL01-02A

Size	H(mm)	W(mm)	D(mm)	Head	Tail
1-1/2"	195	182	26.6	BS336	38mm
1-3/4"	195	182	32.9	BS336	45mm
2"	195	182	38.5	BS336	51mm
2-1/2"	195	182	51.2	BS336	63.5mm
2-3/4"	195	182	56.8	BS336	75mm

BS Female Adaptor

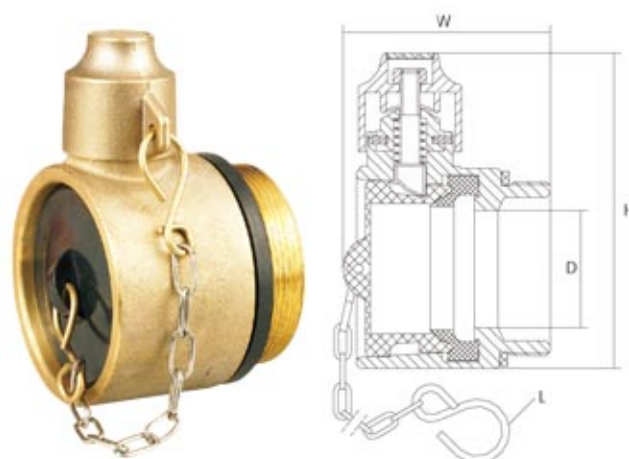

TSL01-03A

Size	H(mm)	W(mm)	D(mm)	Head	Tail
2"	80	130	45	BS336	2"BSP
2-1/2"	80	130	53	BS336	2.5"BSP
2-1/2"	80	130	53	BS336	2.5"BSP

Storz Adaptor with Male Thread

TSL01-04C

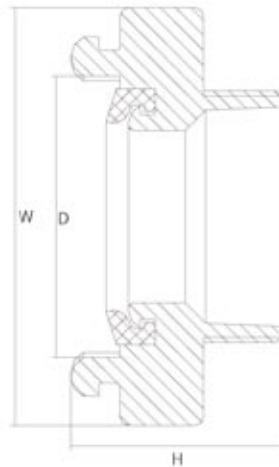

Size	H(mm)	W(mm)	D(mm)	Head	Thread
DN25	38	55	31	Storz-D	G3/4"
DN25	38	55	31	Storz-D	G1"
DN38	45	80	51	1-1/2"Storz	G1-1/2"
DN38	45	80	51	1-1/2"Storz	G2"
DN45	45	85	59	1-3/4"Storz	G1-3/4"
DN45	45	85	59	1-3/4"Storz	G2"
DN52	45	98	66	Storz-C	G2"
DN65	50	118	81	2-1/2"Storz	G2"
DN65	50	118	81	2-1/2"Storz	G2-1/2"
DN65	50	118	81	2-1/2"Storz	NSW
DN75	55	126	89	Storz-B	G2-1/2"
DN75	55	126	89	Storz-B	G3"
DN100	60	156	115	4"Storz	G4"
DN110	65	182	133	Storz-A	G4"
DN125	70	196	148	5"Storz	G5"
DN150	78	215	160	6"Storz	G6"

Storz Adaptor with Female Thread

TSL01-05C

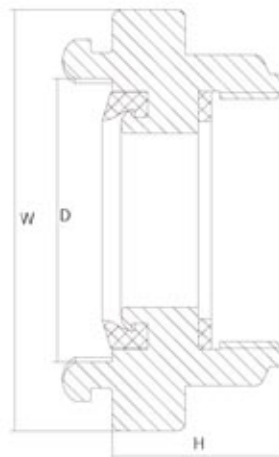

Size	H(mm)	W(mm)	D(mm)	Head	Thread
DN25	38	55	31	Storz-D	G3/4"
DN25	38	55	31	Storz-D	G1"
DN38	45	80	51	1-1/2"Storz	G1-1/2"
DN38	45	80	51	1-1/2"Storz	G2"
DN45	45	85	59	1-3/4"Storz	G1-3/4"
DN45	45	85	59	1-3/4"Storz	G2"
DN52	45	98	66	Storz-C	G2"
DN65	50	118	81	2-1/2"Storz	G2-1/2"
DN65	50	118	81	2-1/2"Storz	NSW
DN65	50	118	81	2-1/2"Storz	CFA
DN75	55	126	89	Storz-B	G2-1/2"
DN75	55	126	89	Storz-B	G3"
DN100	60	156	115	4"Storz	G4"
DN110	65	182	133	Storz-A	G4"
DN125	70	196	148	5"Storz	G5"
DN150	78	215	160	6"Storz	G6"

Storz Hose Coupling

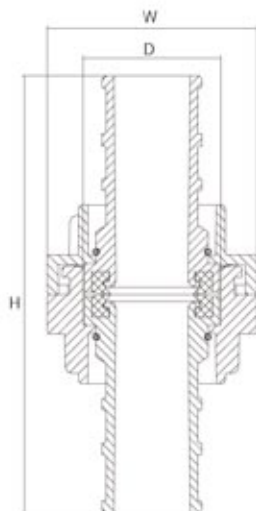

TSL01-06C

Size	H(mm)	W(mm)	D(mm)	Head	Tail
DN25	53	55	31	Storz-D	19mm
DN25	53	55	31	Storz-D	25mm
DN38	80	80	51	1-1/2"Storz	38mm
DN45	85	85	59	1-3/4"Storz	45mm
DN52	65	98	66	Storz-C	45mm
DN52	65	98	66	Storz-C	51mm
DN52	90	98	66	Storz-C	51mm
DN65	90	118	81	2-1/2"Storz	51mm
DN65	65	118	81	2-1/2"Storz	65mm
DN65	95	118	81	2-1/2"Storz	65mm
DN75	115	126	89	Storz-B	65mm
DN75	115	126	89	Storz-B	70mm
DN75	65	126	89	Storz-B	75mm
DN75	125	126	89	Storz-B	75mm
DN110	115	182	133	Storz-A	100mm
DN110	170	182	133	Storz-A	100mm

Storz Hose Coupling

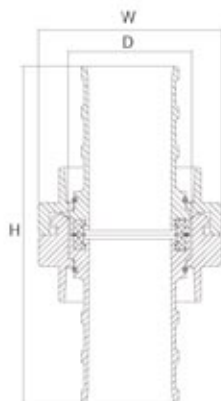

TSL01-07A

Size	H(mm)	W(mm)	D(mm)	Head	Tail
DN25	53	55	31	Storz-D	19mm
DN25	53	55	31	Storz-D	25mm
DN40	80	80	51	1-1/2"Storz	38mm
DN52	65	98	66	Storz-C	51mm
DN52	90	98	66	Storz-C	51mm
DN65	65	118	81	2-1/2"Storz	65mm
DN65	95	118	81	2-1/2"Storz	65mm

Force Resistance

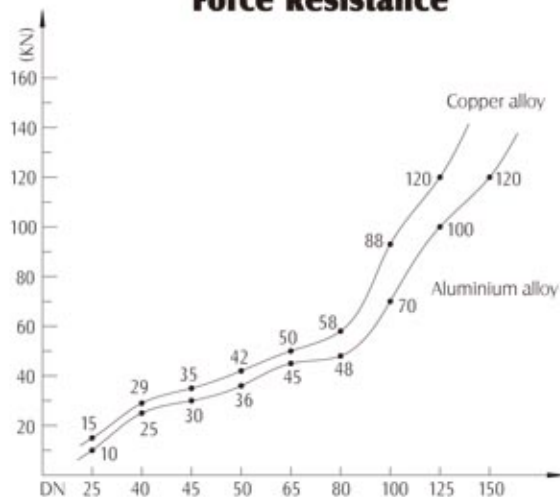

UNI Hose Coupling (Type A)

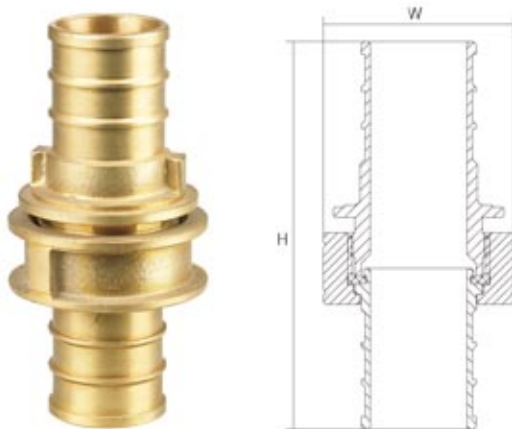

TSL01-08A

Size	H(mm)	W(mm)	UNI	Tail
UNI25	110	47	M34×3	25mm
UNI45	155	75	M56×4	45mm
UNI70	195	105	M85×6	70mm

Machino Hose Coupling

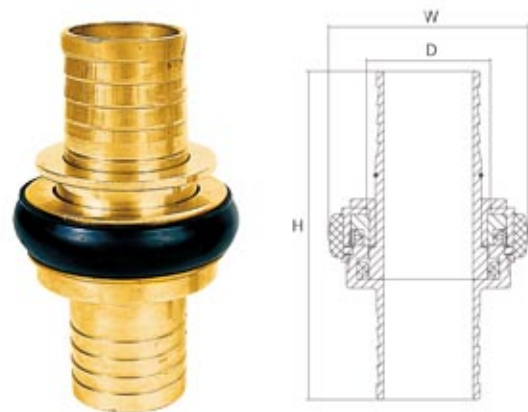

TSL01-09A

Size	H(mm)	W(mm)	D(mm)	Machino	Tail
40A	120	73	46	1.5"	38mm
50A	150	90	59	2"	50mm
65A	183	106	73	2.5"	65mm

DSP Hose Coupling/Ribbed & Surrated

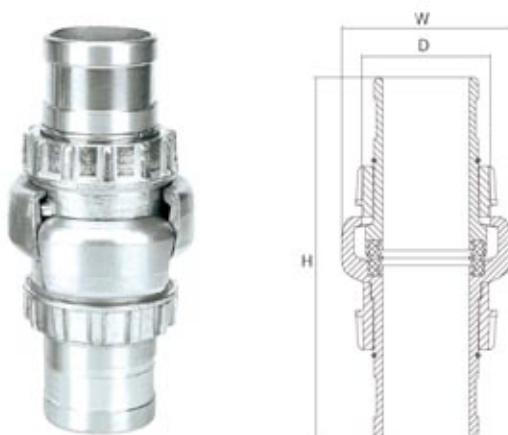

TSL01-10C

Size	H(mm)	W(mm)	D(mm)	Head	Tail
DN40	155	76	55	DSP40	45mm
DN65	172	108	84	DSP65	70mm
DN100	282	149	123	AR100	110mm

Force Resistance



Aluminium alloy to EN1706

WP: 25bar TP: 38bar BP: 75bar

2 Ways Fire Hydrant With Valves

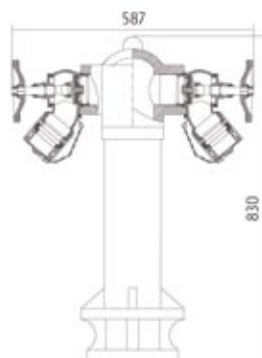

TSY01-01A

Inlet	Outlet	Test Pressure
DN100 With Flange	2.5"NST×2	435 psi 30 bar
	BS336×2	
	2.5"Storz×2	
Weight	Material	
60Kg	Body: Cast Iron BS 1452	
	Valves: Brass or Bronze	

2 Ways Fire Hydrant

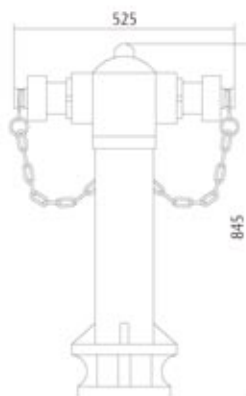

TSY01-02A

Inlet	Outlet	Test Pressure
DN100 With Flange	NSW×2	435 psi 30 bar
	2.5"Storz×2	
	BS336×2	
Weight	Material	
65Kg	Body: Cast Iron BS 1452	
	Adapter: Brass or Bronze	

3 Ways 6" Fire Hydrant with valves

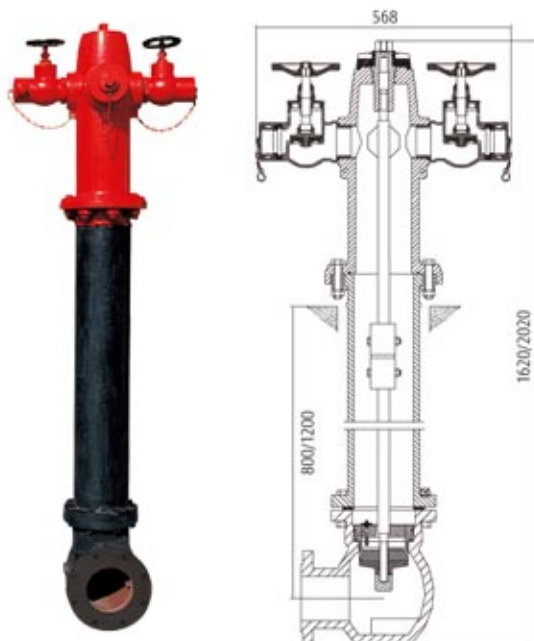

TSY01-03A

Inlet	Outlet	
DN150 With Flange 800mm	2.5"NH×2	4"NH
	2.5"Storz×2	4"Storz
	BS336×2	4"BSRT
Weight	Material	
180Kg	Body: Cast Iron BS 1452	
	Adapter: Brass or Bronze	
Inlet	Outlet	
DN150 With Flange 1200mm	2.5"NH×2	4"NH
	2.5"Storz×2	4"Storz
	BS336×2	4"BSRT
Weight	Material	
205Kg	Body: Cast Iron BS 1452	
	Adapter: Brass or Bronze	

3 Ways 4" Fire Hydrant

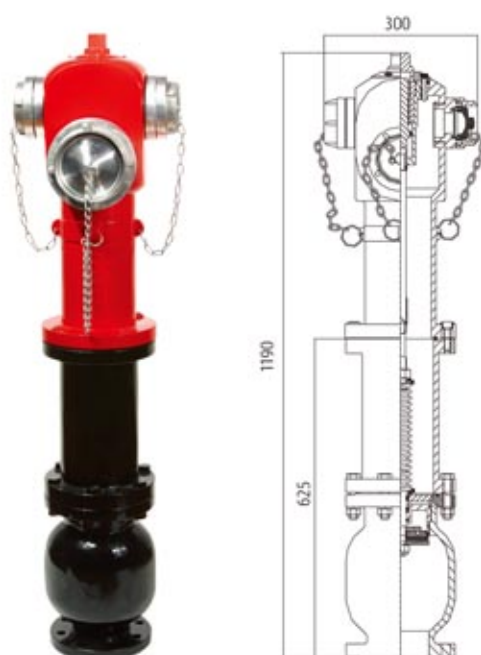

TSY01-04A

Inlet	Outlet	
DN100 With Flange	UNE 65×2	UNE100
	DSP 65×2	AR100
	2.5"Storz×2	4"Storz
Weight	Material	
80Kg	Body: Cast Iron BS 1452	
	Valves: Brass or Bronze	
Inlet	Outlet	
DN100 With Flange & Duck foot	UNE 65×2	UNE100
	DSP 65×2	AR100
	2.5"Storz×2	4"Storz
Weight	Material	
90Kg	Body: Cast Iron BS 1452	
	Adapter: Brass or Bronze	

OS&Y Type Gate Valves

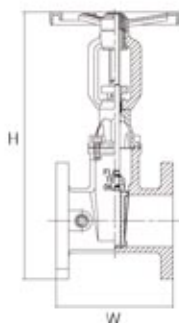

TSV02-01A

Size	H(mm)	W(mm)	Flange	Handwheel
DN100	510	230	228	255
DN150	700	270	280	305

SPECIFICATION OF GATE VALVES

Standard	FM1120 & FM1130
Body material	Ductile iron
Stem material	Stainless steel
Flange	ANSI B 16 or BS 4504
Packing material	EPDM
Applicable temperature	-10°C ~ ≤100°C
Working pressure	16bar
Strength test	48bar
Surface	Red powder coating

NRS Type Gate Valve with Indicator Posts Flange

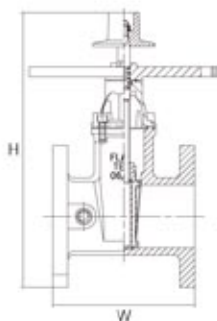

TSV02-02A

Size	H(mm)	W(mm)	Flange
DN100	445	230	228
DN150	565	270	280

Alarm Check Valve



TSV03-01A

Size	H(mm)	W(mm)	Flange
DN100	230	225	220
DN150	255	280	280



TSC01-010A

Specifications		Characteristic	
Size	1.0mm2×2C	Conductor Resistance	18 Ω/KM
Center Conductor	1.12±0.02mm BC	Insulation Resistance	200 M.Ω×KM
Dielectric	2.10mm PVC	Operating Voltage	300V/500V
Shield	PET+Bonded Al Foil	Test Voltage	2.5KV
Drain Wire	0.8mm AL	Temperature Range	-20℃-75℃
Jacket	4.70±0.05mm PVC	Package	100m/plastic spool



TSC01-015A

Specifications		Characteristic	
Size	1.5mm2×2C	Conductor Resistance	12 Ω/KM
Center Conductor	1.38±0.02mm BC	Insulation Resistance	200 M.Ω×KM
Dielectric	2.20mm PVC	Operating Voltage	300V/500V
Shield	PET+Bonded Al Foil	Test Voltage	2.5KV
Drain Wire	0.8mm AL	Temperature Range	-20℃-75℃
Jacket	5.20±0.05mm PVC	Package	100m/plastic spool



TSC01-025A

Specifications		Characteristic	
Size	2.5mm2×2C	Conductor Resistance	7.4 Ω/KM
Center Conductor	1.76±0.02mm BC	Insulation Resistance	200 M.Ω×KM
Dielectric	2.75mm PVC	Operating Voltage	300V/500V
Shield	PET+Bonded Al Foil	Test Voltage	2.5KV
Drain Wire	0.8mm AL	Temperature Range	-20℃-75℃
Jacket	7.50±0.05mm PVC	Package	100m/plastic spool



TSC01-016

Specifications		Characteristic	
Size	16AWG×2C	Conductor Resistance	7.4 Ω/KM
Center Conductor	1.29±0.003mm BC	Insulation Resistance	200 M.Ω×KM
Dielectric	1.80mm PVC	Operating Voltage	300V/500V
Shield	/	Test Voltage	2.5KV
Drain Wire	/	Temperature Range	-20℃-75℃
Jacket	4.40±0.01mm PVC	Package	100m/plastic spool



TSC01-032

Specifications		Characteristic	
Size	1.25mm2×2C	Conductor Resistance	7.4 Ω/KM
Center Conductor	0.32×16×2Cmm TC	Insulation Resistance	200 M.Ω×KM
Dielectric	2.70mm PVC	Operating Voltage	300V/500V
Shield	/	Test Voltage	2.5KV
Drain Wire	/	Temperature Range	-20℃-75℃
Jacket	7.90±0.01mm PVC	Package	100m/plastic spool

Sincerely we present this catalog to introduce our business range and hope it would help you to know us better. The products listed are elaborately selected for your reference but we are able to do more to meet your diversified needs. We would always like to offer you the best and most reliable fire prevention & protection products within our ability and resources. Anytime, we will be very pleased to help you with any query and so honored to have your comments to improve our service.

Should you need any further information, please do not hesitate to contact us.

chris@top-safefire.com / sales@top-safefire.com

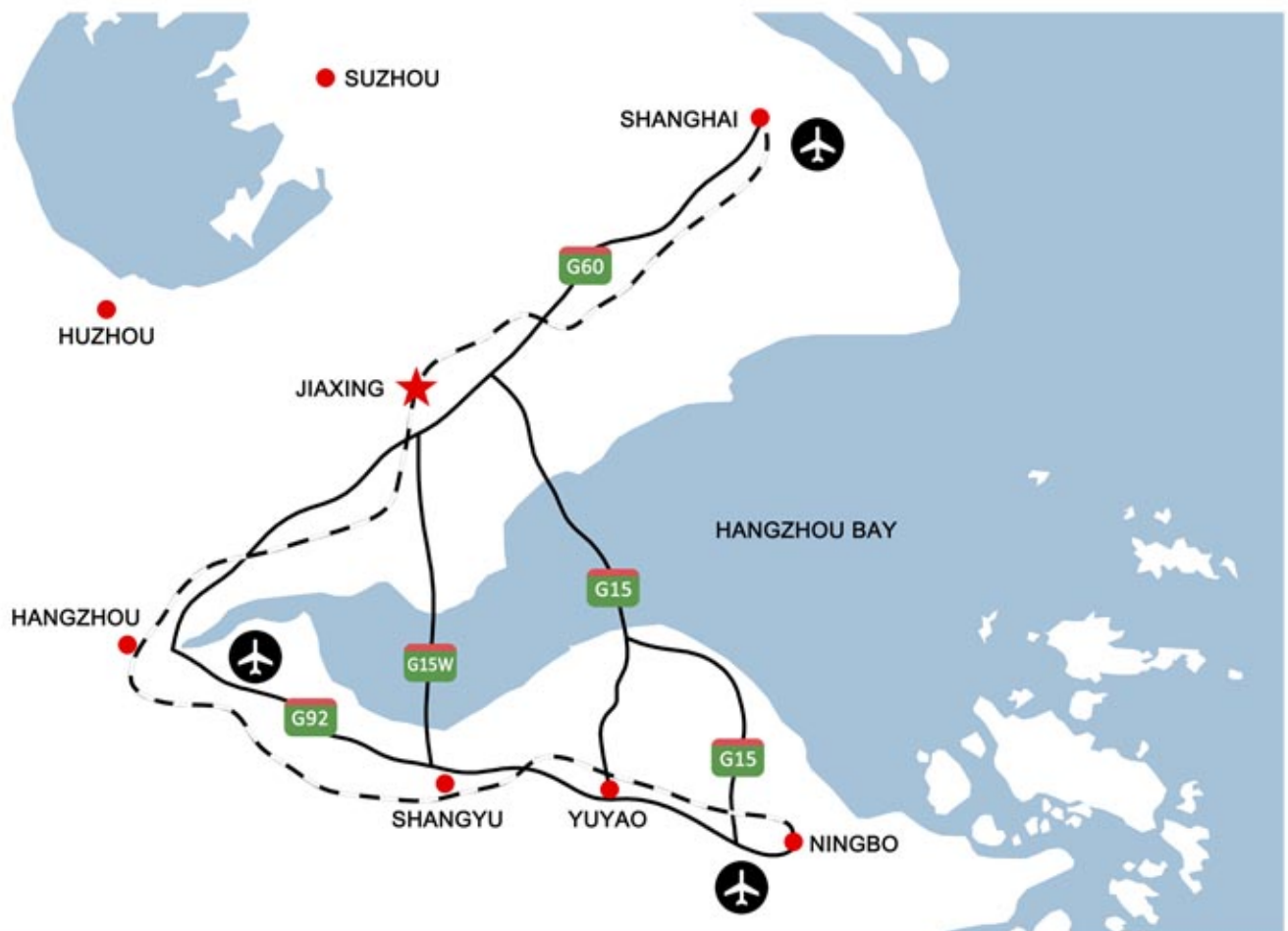

SHANGHAI — JIAXING	100km
HANGZHOU — JIAXING	87km
JIAXING — SHANGYU	95km
JIAXING — YUYAO	125km
JIAXING — NINGBO	150km

— RAILWAY	— HIGHWAY
G60 SHANGHAI-HANGZHOU HIGHWAY	
G92 HANGZHOU-NINGBO HIGHWAY	
G15 HANGZHOU BAY BRIDGE	
G15W JIASHAO BRIDGE	

